

- 1) Cut out template on dotted line
- 2) Tape template over hole on cane
- 3) With a sharp awl, punch marks into cane ready for drilling
- 4) Use # 26 drill. Make sure that the 2 holes will be drilled directly in center of aluminum tube.
- 5) **Use caution, DO NOT drill wires**  
Keep wires to one side when drilling the hole.
- 6) Wire to switch and insulate well by wrapping teflon tape around switch or you may splice wires then cover with shrinkable tubing.
- 7) Install 6-32x1-1/8" screws Qua. 2 do not overtighten as not to strip the threads in the adapter block.

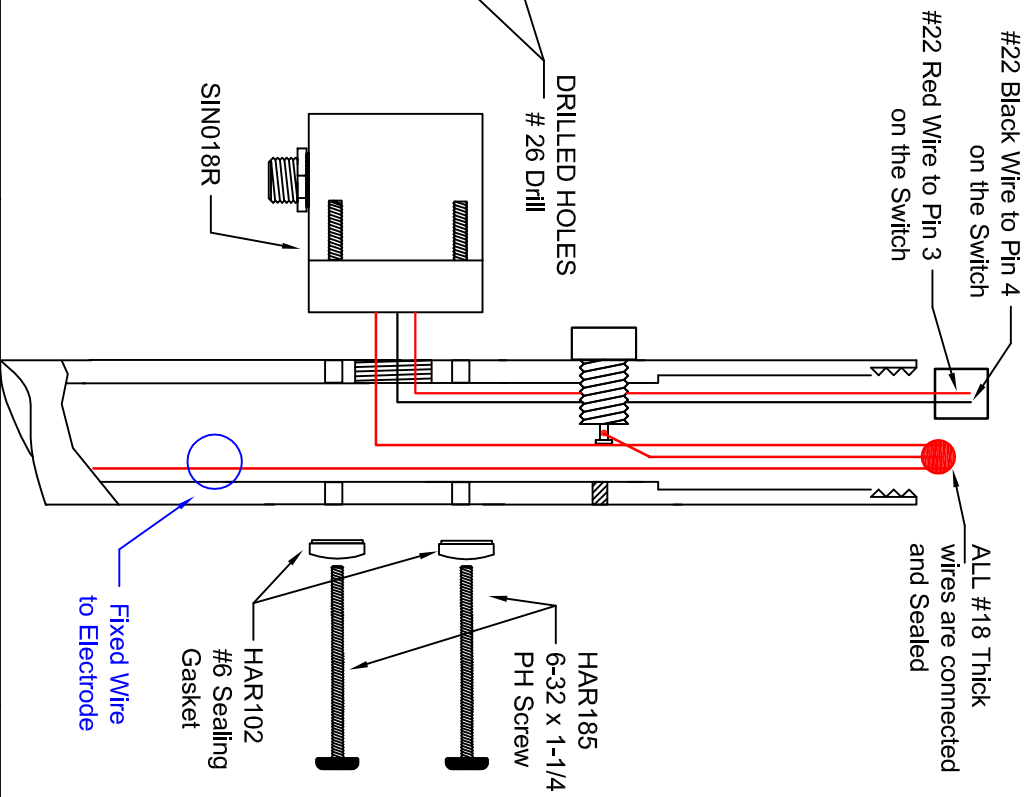
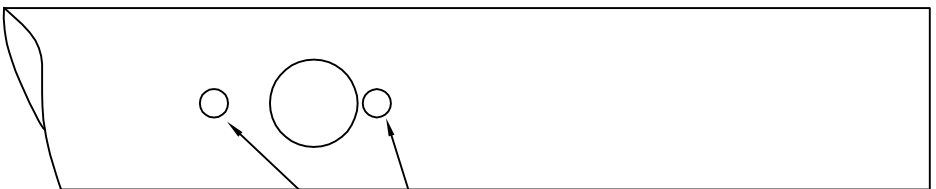
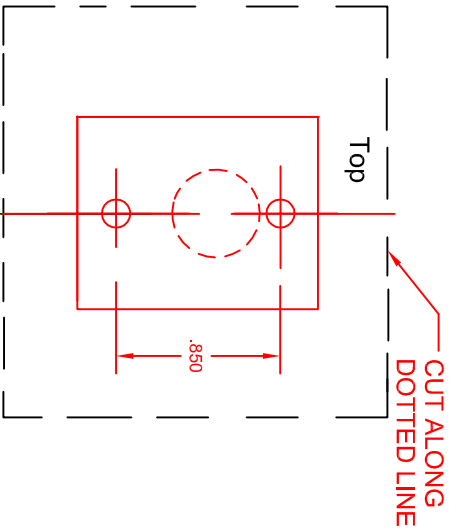

REVISIONS	DATE	REV	DESCRIPTION	BY

Material:	Title:	M.C. Miller Co. Inc. 11640 US Hwy #1 Sebastian, FL 32958 772-794-9448 al@mcmiller.com	DRN:	A. J. Hilberts	Part #	REV.
.X = +/- .030 .XX = +/- .015 .XXX = +/- .005	<b>Drill Template</b> <b>Data Probe Adapter Block</b>		Up Dated:	May 20, 2010	<b>SIN018R</b>	
			SCALE	<b>Full</b>	DATE	June 1, 2009
					SHEET	of